

2-1/8" Tachometer (< 8000 RPM)

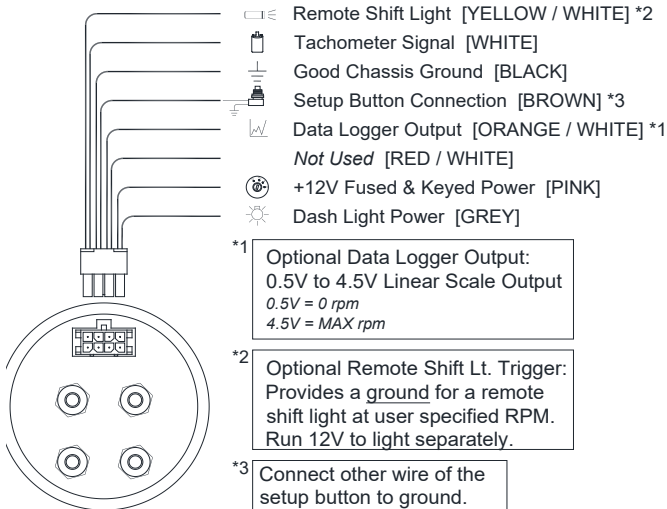

To Set Backlight Color:

1. Start with power off.
2. Press and hold pushbutton.
3. While pressing pushbutton, apply power to the gauge (starting vehicle not necessary).
4. Release pushbutton once power is applied.
5. Tachometer pointer will indicate 1/8 scale.
6. Press and hold the pushbutton (with tachometer reading 1/8 scale) until the pointer moves to indicate the backlight color setting.
7. Tapping the pushbutton will cause the pointer to alternate between 1/4 scale "Cold White" and 3/8 scale "Warm White".
8. Press and hold the pushbutton until the pointer returns to 0 RPM to save the setting.

To Set Signal Type:

1. Start with power off.
2. Press and hold pushbutton.
3. While pressing pushbutton, apply power to the gauge (starting vehicle not necessary).
4. Release pushbutton once power is applied.
5. Tachometer pointer will indicate 1/8 scale.
6. Tap the pushbutton to index the pointer to 1/4 scale.
7. Press and hold the pushbutton (with tachometer reading 1/4 scale) until the pointer moves to indicate the signal type.
8. Tapping the pushbutton will cause the pointer to alternate between 5/8 scale "Low Voltage Signal" (from an ECM) and 3/4 scale "High Voltage Signal" (from standard, HEI or CDI {MSD} ignitions).
9. Press and hold the pushbutton until the pointer returns to 0 RPM to save the setting.

Typical Tachometer Signal Sources	
Standard Ignition	(-) Negative Side of Coil
HEI	"TACH" Terminal on Distributor
CDI Ignition (MSD)	Tach Terminal / Wire from Box

To Set Shift Light Trigger Point:

1. Start with power off.
2. Press and hold pushbutton.
3. While pressing pushbutton, apply power to the gauge (starting vehicle not necessary).
4. Release pushbutton once power is applied.
5. Tachometer pointer will indicate 1/8 scale.
6. Tap the pushbutton twice to index the pointer to 3/8 scale.
7. Press and hold the pushbutton (with tachometer reading 3/8 scale) until the pointer moves to indicate the shift light trigger point.
8. Press and hold the pushbutton to change the RPM shown. The first time the pushbutton is pressed and held, the RPM shown will increase. The second time the pushbutton is pressed and held, the RPM shown will decrease. The RPM shown will alternate between increasing and decreasing each time the pushbutton is pressed.
9. Once the correct RPM shift light trigger point is shown, wait 8 seconds without pushing the pushbutton in order to save the setting. The pointer will return to 0 RPM.

To Set # of Cylinder Signal Type:

1. Start with power off.
2. Press and hold pushbutton.
3. While pressing pushbutton, apply power to the gauge (starting vehicle not necessary).
4. Release pushbutton once power is applied.
5. Tachometer pointer will indicate 1/8 scale.
6. Tap the pushbutton to index the pointer to 1/2 scale "4-cylinder", 3/4 scale "6-cylinder" or Full scale "8-cylinder".
7. Press and hold the pushbutton with the pointer indicating the desired setting (1/2, 3/4 or Full scale) to set the signal type. Once set, the pointer will return to 0 RPM.

Important: Turn power OFF to the tachometer to save changes